



Signature Tower



The complex is designed to live up to its name. Supremely graceful, offering the ambience and sense of space usually associated with an independent house. Each apartment is designed to welcome fresh air and light. So you will get the best urban living space, high quality specification, facilities and imaginative landscaping all around.

Specifications

Structure : Earthquake resistant R.C.C. frame structure

Toilet Walls : Dado up to 7' height of glazed ceramic designer tiles

Toilet Flooring : Ante skid/ ceramic Tiles

Plumbing : All internal plumbing sanitation work will be concealed C.P fitting.

Water supply : 24 hrs. supply. Submersible tube well with over head tank filled.

Kitchen : Pre-polished Granite /Marble platform with stainless steel sink.

Windows : Aluminum powder coated / wooden frame with clear glasses.

Electrical : Copper concealed ISI wiring provision for lights, plugs points in each bed room.

Doors : Hardwood framed & designer compressed doors.

Wall Finish : P.O.P. on walls and ceiling painted with Oil bound distemper on Ceiling and velvet touch on walls

Floor : Vitrified Tiles

Exclusive:

1. Master bed rom with wooden floor
2. Elegant entrance lobby and gate for the tower



Signature

Tower

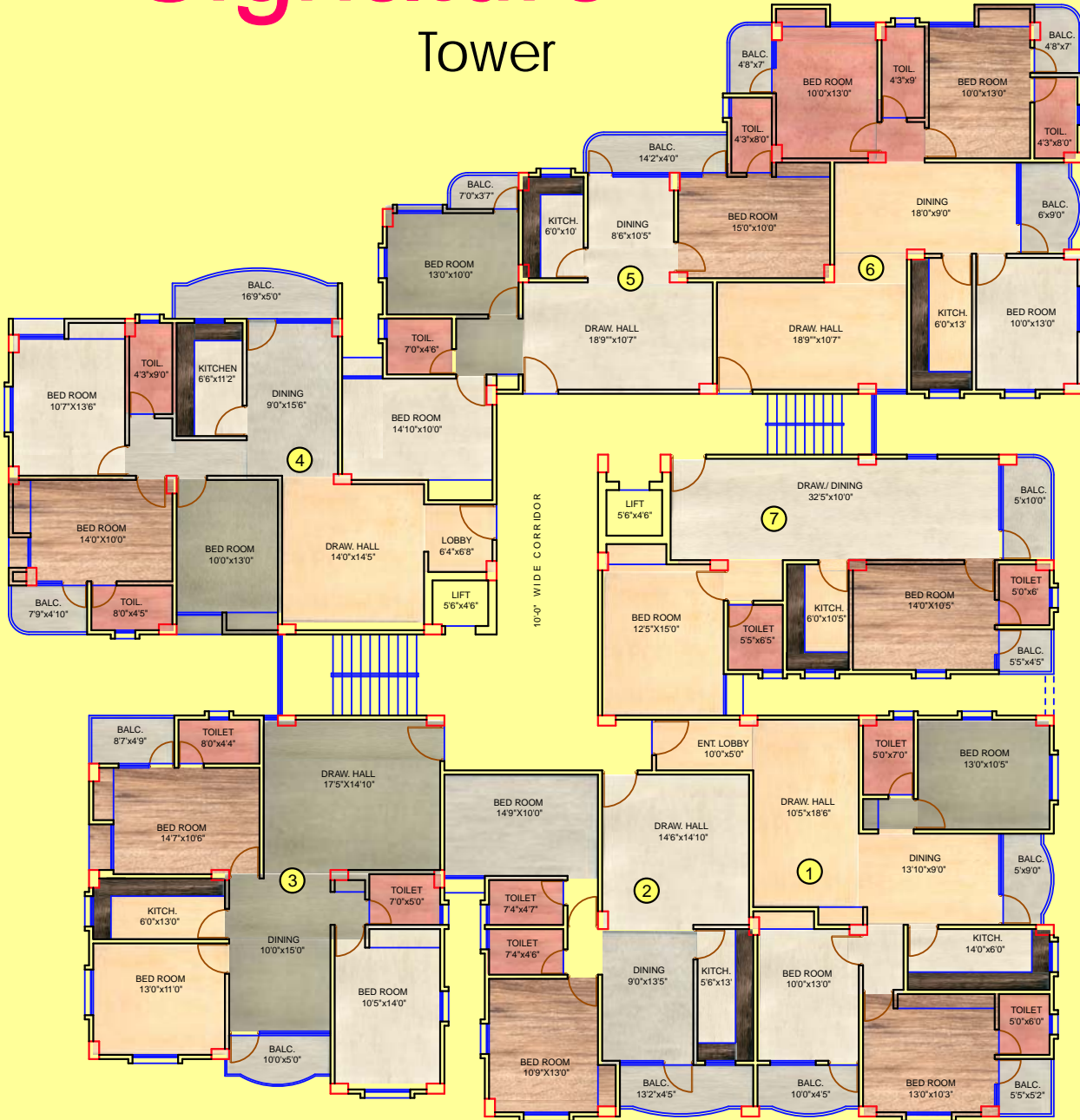

AREASTATEMENTS	
TYPE	SUPER BU AREA
1	1500 sqft.
2	1150 sqft.
3	1510 sqft.
4	1550 sqft.
5	1300 sqft.
6	1410 sqft.
7	1170 sqft.



SYSTEMEX

COLONISERS & BUILDERS PVT. LTD.

Regd. Office : Godavari Apartments
Ashiana Nagar Rd., Patna - 800 014

Mob : 9431009208, 9798891684, 9835087451

NORTH



DRN BY

SHUBHAM KUMAR

DATE

22-12-2008

PROJECT

SIGNATURE TOWER

DEVELOPER

**SYSTEMEX
COLONISERS & BUILDERS
PVT. LTD.**

CITY PLANNERS
ARCHITECTS ENGINEER
MOBILE NO.-98350-64710

SHEET TITLE
TYPICAL FLOOR PLAN